

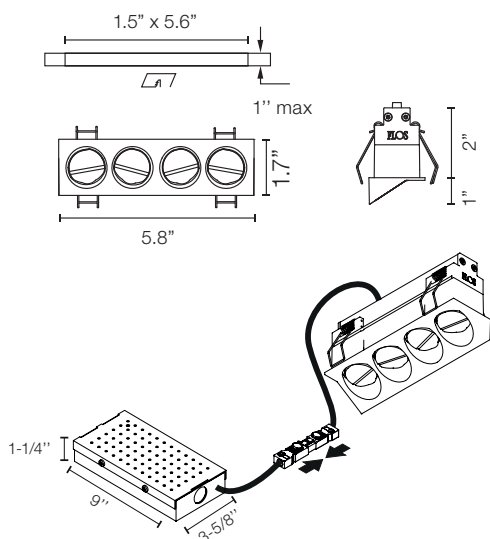

Dimensions



Certifications



Photometrics

For current IES files please visit
arch.flosusa.com

Warranty

2 years from date of sale.

Light Shadow Wall-Washer, Trim 4L

NON-IC Ceiling Recessed Wall-Washer Downlight.

Description

Flos introduces Light Shadow, a revolution in low-glare lighting. A patented and unique optical solution in this new family reaches extreme cut off angles without sacrificing efficiency. The optics have been designed exclusively by FLOS and guarantee maximum control and uniformity of the beam. Light Shadow is a downlight that can be perfectly incorporated into any architecture because of its extraordinary compact size that allows the integration even when there is a minimum space. The collection is available in 2/4/8/or 12 spots, trimmed or trimless, and fixed or adjustable. It can be mounted in a continuous row. The Light Shadow 4 spot is also available as a light element for Running Magnet 2.0.

Lamp

Lamps Type	LED
Wattage	10.8W
Initial Lumens	1080lm, 1140lm
Color Temperature	2700K, 3000K, 3500K* (See Notes)
Color rendering	CRI 90

Optical

Beam Angle	22°
Lighting Type	Direct
Light Distribution	Asymmetric

Physical

Material	Aluminum
Aiming	Fixed
Weight	Fixture: 0.75 Pounds
Ingress Protection Rating	IP23

Finishes:

☐ 40 White ☒ 14 Black



Installation type	Ceiling Recessed - Non IC
Environment	Indoor
Minimum Plenum height	6"
Maximum Ceiling thickness	0.98"



Dimensions

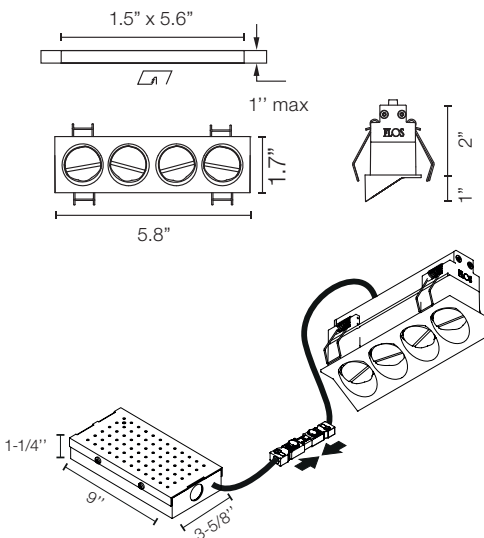

Certifications



Photometrics

For current IES files please visit
arch.flosusa.com

Warranty

2 years from date of sale.

Light Shadow Wall-Washer, Trim 4L

NON-IC Ceiling Recessed Wall-Washer Downlight.

Electrical & Control

Driver Input Voltage	120V or 277V (depending on Selected Splice Box)
Control	0-10V and ELV
Driver	Integral - Splice Box
Current	900mA

Performance

Delivered Lumens	From 684lm To 730lm
Efficacy	67.6lm/W

Notes

Black reflector provides the greatest comfort level

Integral LED board is not field replaceable.

Splice Box is installed from below.

Non IC rated luminaire

Splice Box required has to be ordered separately always from FLOS. 3 Standard Options:

- 0-10V Dimming 120V
- 0-10V Dimming 277V
- ELV Dimming 120V

3500K and other CCT available but not cataloged. Consult factory for additional color temperatures.

Light Shadow Wall-Washer, Trim 4L

NON-IC Ceiling Recessed Wall-Washer Downlight.

How to specify

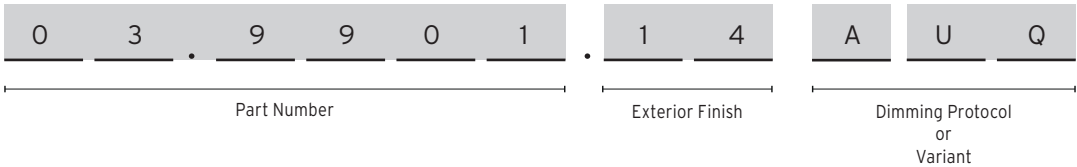

How to Specify ex. 03.9901.40AUQ

CCT*	CRI	Initial Lumens	Delivered Lumens	Watts	Part Number	Exterior Finish	Variant
2700	90	1080	684	10.8	03.9901	<div>40 = White</div> <div>14 = Black</div>	AUQ : US product. Splice Box* not included. *Has to be Always supply by FLOS
3000	90	1140	730	10.8	03.9900	<div>40 = White</div> <div>14 = Black</div>	

* 3500K and other CCT available but not cataloged. Consult factory for additional color temperatures.

Photometrics

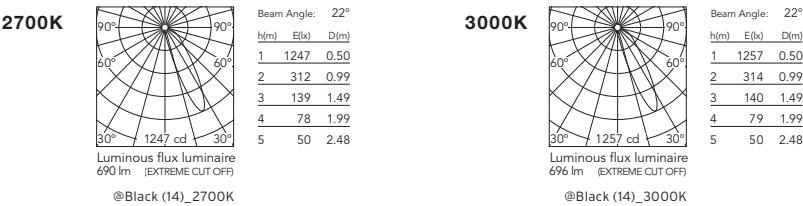

Light Shadow Wall-Washer, Trim 4L

NON-IC Ceiling Recessed Wall-Washer Downlight.

Required Accessories

Table with 3 columns: Accessory description, Part number, and Diagram.
Row 1: Splice Box 25W, 1% dim, 0-10V, 120V. Size: 9" x 3.59" x 1.25". Part: SP25W900MA-120-A01. Diagram shows a rectangular box with dimensions 9", 3-5/8", and 1-1/4".
Row 2: Splice Box 25W, 1% dim, 0-10V, 277V. Size: 9" x 3.59" x 1.25". Part: SP25W900MA-277-A01. Diagram shows a rectangular box with dimensions 9", 3-5/8", and 1-1/4".
Row 3: Splice Box 20W, 20% dim, ELV, 120V. Size: 9" x 2.22" x 1.25". Part: SP20W900MA-ELV-C01. Diagram shows a rectangular box with dimensions 9", 1-1/4", and 3-5/8".

Tray - Optional Accessories

Table with 2 columns: Accessory description and Diagram.
Row 1: Registration tray -non electrical, place holder for non IC new construction, 6.14" x 2". Part: TRAY-0035. Diagram shows a rectangular tray with dimensions 14" x 10" and various internal offsets (4.8", 2.7", 0.7", 1.5", 5.6", 1.9", 0.5"). A callout indicates '0.06" Thick Aluminum'.

Light Shadow Wall-Washer, Trim 4L

NON-IC Ceiling Recessed Wall-Washer Downlight.

How to install

A. Select desired Part number

B. Select required dimming protocol

C. Position the fixture

In order to have a better performance position the Light fixture 0.8m-31.5inch from the wall and 0.8m-31.5inch space between two consecutive downlights

